



Objective Balance and Cognitive Testing on the mobile device you and your athletes already own.

- ✓ Balance Testing
- ✓ Cognitive Testing
- ✓ FDA Class II Medical Device

REPLACES: ImPACT, SCAT5, and more



USE CASES

Baseline Testing

🕒 20 minutes

Baseline testing can be performed on any flat surface, in person or remotely. Devices used for testing must be connected to the internet to perform the baseline test.

Sideline Evaluations

🕒 5 minutes

Sway screenings can be performed in under 5 minutes on the sideline during the game. With immediate results, you can quickly compare the athlete's current scores to their baseline as well as normative data based on the athlete's age and sex.

Return-to-Learn & Return-to-Play

Unlimited tests per athlete allows you to provide the best care for your athletes, testing cognition, balance, and gathering symptoms as often as you'd like.

- ✓ Unlimited Testing
- ✓ Remote Symptom Tracking

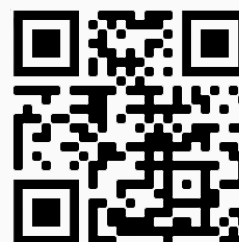
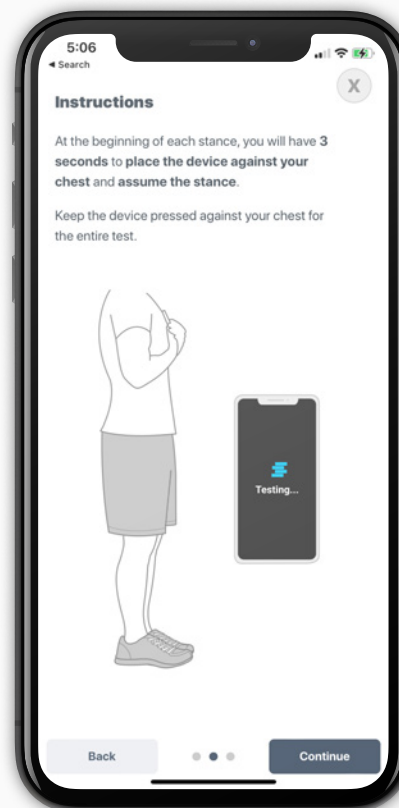

Download on iOS and Android